

Siphon

All stainless steel



Features:

- Pigtail, Coil and "U" type shapes
- Maximum temperature up to 400 °C
- Nominal pressure up to 160 kgcm²
- TIG welding & hydro tested
- Made with seamless pipes

Applications:

- Siphons are used mainly to protect process instruments, gauges, switches and transmitter directly coming in contact with high temperature process fluids or vapours
- These are mounted between process and pressure instrument
- They reduce process pulsation generate cooling effect to save the instrument

Standard Parameters:

Body material : AISI 316 stainless steel
 Pipe Size : 1/2", Schedule 40
 Operating pressure : 100 kg/cm²

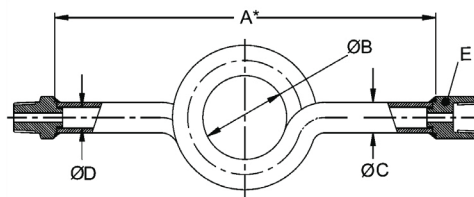

Coil Type					
Pipe Size	A	øB	øC	øD	E
1/2" Sch. 40	270	61.5	21.3	15.7	25
1/2" Sch. 80	270	61.5	21.3	13.9	25
1/2" Sch. 160	270	61.5	21.3	11.7	25

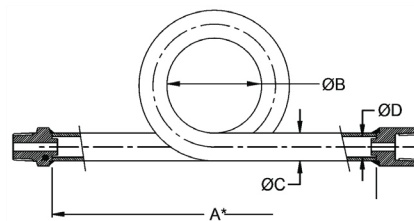

Pigtail Type					
Pipe Size	A	øB	øC	øD	E
1/2" Sch. 40	270	61.5	21.3	15.7	25
1/2" Sch. 80	270	61.5	21.3	13.9	25
1/2" Sch. 160	270	61.5	21.3	11.7	25

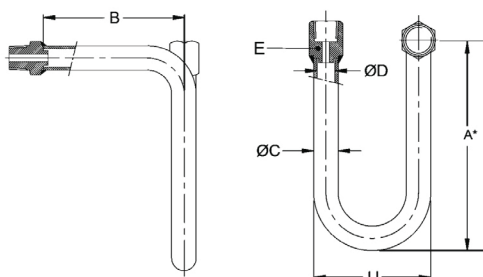

U Type						
Pipe Size	A	øB	U	øC	øD	E
1/2" Sch. 40	169	155	99	21.3	15.7	25
1/2" Sch. 80	169	155	99	21.3	13.9	25
1/2" Sch. 160	169	155	99	21.3	11.7	25

Ordering codes

1. Type		C	5. Connection		15B.
C	Coil type			6B.6BF	1/4" BSP [M x F]
P	Pigtail type		6N.6NF	1/4" NPT [M x F] *	
U	U type		10B.10BF	3/8" BSP [M x F]	
2. Body		S4	10N.10NF	3/8" NPT [M x F] *	
S4	AISI 304 SS		15B.15BF	1/2" BSP [M x F]	
S6	AISI 316 SS		15N.15NF	1/2" NPT [M x F] *	
S6L	AISI 316L SS		15N.PE	1/2" NPT [M] x plain end	
CS	Carbon steel (red oxide painted)		6B.6B	1/4" BSP [M x M]	
3. Pipe Size & Schedule		1/4 .40	6N.6N	1/4" NPT [M x M]	
1/4"	40		10B.10B	3/8" BSP [M x M]	
1/4"	80		10N.10N	3/8" NPT [M x M]	
3/8"	40		15B.15B	1/2" BSP [M x M]	
3/8"	80		15N.15N	1/2" NPT [M x M]	
1/2"	40		6BF.6BF	1/4" BSP [F x F]	
1/2"	80		6NF.6NF	1/4" NPT [F x F] *	
1/2"	160		10BF.10BF	3/8" BSP [F x F]	
4. Connection type		SF	10NF.10NF	3/8" NPT [F x F] *	
SF	Swivel female		15BF.15BF	1/2" BSP [F x F]	
MF	Male or female adaptor		15NF.15NF	1/2" NPT [F x F] *	
M	Male thread on pipe		* Not applicable for SF connection type		
			6. Options	MT	
		IB	IBR approval		
		ML	Marking by laser		
		MT	Material test certificate		
		ST	SS tag plate		

Ordering Example: SI-C-S4-1/4.40-SF-15B.15BF-MT

Note: Specifications and dimensions given in this product catalogue represents the state of engineering at the time of printing. Modifications may take place and materials specified may be replaced by others without prior notice.