

Flushing ring

All stainless steel



Features:

- With double flushing ports.
- Suitable with flanged, pancake or inline diaphragm seals.
- Available in all exotic material grades.

Applications:

- The flushing ring is designed to be sandwiched between the process flange & the diaphragm seal.
- Material collected in front of diaphragm can be flushed out through the flushing ports.

Standard Parameters

Flange size	: ½" to 5" as per ANSI B 16.5
Material	: AISI 316 SS
Number of ports	: Two
Port connection	: 1/4" NPT[F] with male plug
Sealing face	: Suitable to raised face of flange

Dimensional drawing

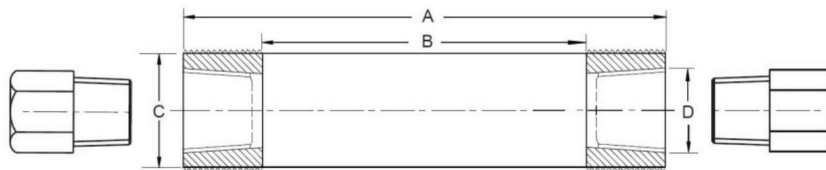

Flange Size	Class	A	B	C	D
1/2"	150 # to 600 #	35	12	30	1/4" NPT[M] or 1/2" NPT[F]
3/4"		43	20	30	
1"		51	25	30	
1 1/2"		73	43	30	
2"		92	62	30	
3"		127	92	30	
4"		157	92	30	
5"		185.5	126	30	

Note: ● Drawings are not to scale ● All dimensions are in mm

Ordering Codes

1. Flange Size (As per ANSI B 16.5)		2I
HI	1/2"	
QI	3/4"	
1I	1"	
1.5I	1 1/2"	
2I	2"	
3I	3"	
4I	4"	
5I	5"	
2. Flange Rating		150
150	150	
300	300	
400	400	
600	600	
3. Sealing Face		RF
RF	Raised face (standard)	
FF	Flat face	
4. Flushing Ring Material		S6
S6	AISI 316 SS	
S6L	AISI 316L SS	
HC	Hastelloy C	
MO	Monel	
CS	Carbon steel	
TI	Titanium	
5. Flushing Ports		15NF
06NF	1/4" NPT[F] (standard)	
15NF	1/2" NPT[F]	
6. Other Options		MT
MT	Material Test Certificates*	
<small>*Note: Material test certificates will be provided for wetted parts only with chemical composition testing. For others, please consult factory.</small>		

Ordering example: FR-2I-150-RF-S6-15NF-MT

- Specifications and dimensions given in this product catalogue represents the state of engineering at the time of printing. Modifications may take place and materials specified may be replaced by others without prior notice.
-