

Diaphragm seal

Direct coupled (Compact type)

Features:

- Compact design
- Low-cost version
- All SS construction
- The diaphragm is welded to the body to ensure separation of the filling fluid from the process medium.

Applications:

- Diaphragm seals are designed to isolate the sensing element of pressure gauges and pressure switches from process fluids that they may be corrosive, viscous, sedimentous and / or with a high temperature.

Standard Parameters

Range	: 1 to 21 kg/cm ²
Process temperature	: - 40 °C to 200 °C or as per fill fluid
Instrument connection	: 1/4" BSP[F]
Process connection	: 1/4" BSP[M]
Fill fluid	: Silicon Oil - DC 200

Materials of Construction

Diaphragm	: AISI 316L SS
Body	: AISI 316 SS

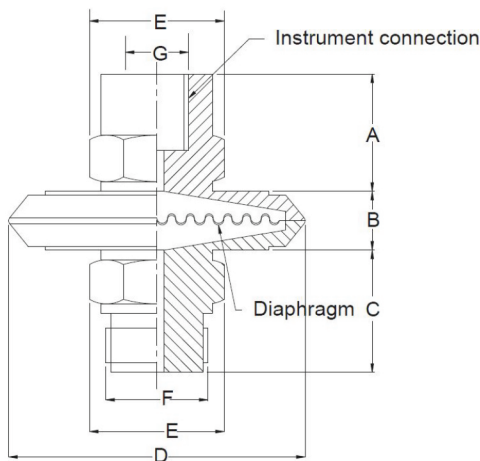
Dimensional drawing

A	B	C	D	E	F	G	Wt.
26	14	23	62	Hex A/F 19	1/4" BSP[M]	1/4" BSP[F]	260
Wt. = Approx. weight in grams							

Note: ● Drawings are not to scale ● All dimensions are in mm

Ordering Codes

1. Instrument Connection		06BF
06BF	1/4" BSP[F]	
06NF	1/4" NPT [F]	
2. Body		S6
S6	AISI 316 SS	
3. Diaphragm		S6L
S6L	AISI 316L SS (Standard)	
4. Process Connection		06B
06B	1/4" BSP[M]	
06N	1/4" NPT[M]	
5. Filling Fluid		FG
S1	Silicon DC 200 [-40 to 205°C]	
S2	Silicon DC 704 [10 to 337°C]	
S3	Silicon DC 710 [7 to 371°C]	
FG	Food Grade Oil [-20 to 140°C]	
6. Other Options		MT
HL	Helium leak test	
WI	Dry Seal Only Without Instrument	
MT	Material Test Certificates*	
<small>*Note: Material test certificates will be provided for wetted parts only with chemical composition testing. For others, please consult factory.</small>		

Ordering example: CD-06BF-S6-S6L-06B-FG-MT

- Specifications and dimensions given in this product catalogue represents the state of engineering at the time of printing. Modifications may take place and materials specified may be replaced by others without prior notice.
-